

St. John's Church, Concord  
Fall Update  
September 2021



Dear St. John's family,

In August, I sent out an online survey through our e-news to get parish feedback on a new worship schedule for the fall: two services (8:00 Rite I and 10:30 Rite II) with Coffee Hour and Sunday School sandwiched in-between our worship. Thank you all for your positive responses and thoughtful comments! I even heard from some 8:00ers that they would prefer a later start time so they could participate in the shared Fellowship/Education hour.

**Beginning Sunday, September 12th** our new Worship and Christian Education schedule is:

**8:30 a.m. Rite I Holy Communion** (traditional, no music)

*This service begins half-an-hour late so that we can have shared Coffee Hour with the second service*

**9:30 a.m. Coffee Hour and Sunday School/Adult Education Series**

*For September and October, our Sunday School and Children's Chapel will meet outdoors*

**10:30 a.m. Rite II Holy Communion** (with hymns and Children's Chapel)

*Following the Gospel, children and Miss Margie will process outside for Children's Chapel*

This new worship schedule allows for some common fellowship between two services, as well as Adult Education Forum time while children meet for Sunday School. Children will be outdoors for both Sunday School and Children's Chapel as part of our COVID mitigation efforts.

While we know that many in our parish hope to return to the three service schedule we had prior to March 2020, at the moment, with the volunteer resources we have as well as our church attendance remaining lower during the ongoing pandemic, a return to three services isn't feasible at this time.

We will maintain a two service schedule on Sundays until our attendance numbers increase and we have the necessary volunteers (from Altar Guild, to lectors, to Eucharistic Ministers, etc.) to support three services.

I know that change is hard, so it will take some time for our parish to get used to this new worship schedule. If it's one thing that life since the pandemic has taught us, it is to be flexible with our plans and be willing to adapt to new practices.

Peace,

Rev. Jill

**Thursday Morning Café  
& Healing Eucharist**

*2nd & 4th Thursdays 10-12pm*

*Drop into the parish hall for coffee & light continental breakfast items. Visit with the St. John's friends you've been missing! A healing Eucharist will follow in the church at 11:30am.*

September 9<sup>th</sup> and 23<sup>rd</sup>      October 14<sup>th</sup> and 28<sup>th</sup>  
November 11<sup>th</sup> [no Café on Thanksgiving 11/25]

December 9<sup>th</sup> and 23<sup>rd</sup> [special Christmas coffee event]

# Happenings for Everyone!

## HOLY HIKERS

2<sup>nd</sup> Saturday of the Month at 10:00

**September 11<sup>th</sup>** – Valley Forge National Park (meet at Knox Headquarters parking lot on Rt. 252)

**October 9<sup>th</sup>** – Location TBA

Join us in the great outdoors! We begin with prayer and then go on a 2-3 mile hike.



## WOMEN'S DINNER

September 22<sup>nd</sup> & October 27<sup>th</sup> at 6pm

Bake, baste, or buy something to share at this monthly potluck dinner that begins at 6pm and concludes with a Bible Study.

## WSFG

3<sup>rd</sup> Tuesdays 7-8:30pm

The Women's Spiritual Formation Group is back! Our first gather will be September 21st.

## WHAT WOULD JESUS BREW? WWJB



1st Wednesdays from 6:30-8pm

Oct 6 (bring Oktoberfest style beers)

Nov 3 & Dec 1 (beer style TBA)

Good conversations often hap-

pen around brewed beverages – beer, coffee, tea. Bring a 6-pack of beer and go home with a mixed-6. We'll dive into questions of our faith like confession and sin, the end times, and even evangelism. Coffee & tea will be available, too.

## WELCOME TO ST. JOHN'S CLASS

Wednesdays from 6:30-8pm:

September 15, 22, and 29

This three-evening class will cover Baptism as our welcome into the Body of Christ; a history of the Episcopal Church; and an instructed Eucharist with Q & A time. In-person and Zoom (meeting ID: 955 049 2211 Code: 1702)

## Children and Youth @ St. John's!

**Sunday School** begins Sept. 12<sup>th</sup> from 9:30-10:15 AM and will continue each Sunday through September and October outside by the Playground. Our theme for these two months will be "Coming Home" and we will discover homecoming stories in the Bible. Miss Margie, Miss Cathy, and helpers have lots of games, crafts, and fun planned for our children from ages 3 to 5<sup>th</sup> grade.

**Children's Chapel** will return on Sept. 19<sup>th</sup>! Following the Gospel reading at our second worship service (10:30 AM), children ages 3 through 5<sup>th</sup> grade will process outside for chapel lead by Miss Margie and her helpers. Our kiddos will hear a Gospel-based children's message and parents will have kid-free time in the main worship service. Children will come back into church at the time of our exchange of Peace.

Finally, our **Youth Group** will gather on the 2<sup>nd</sup> and 4<sup>th</sup> Sundays of the month from 4-5:45 PM beginning September 26<sup>th</sup>. Rev Jill and Jacqui Dunn will lead our Youth Group (6<sup>th</sup> – 12<sup>th</sup> grade) which will be a mix of lessons and games. Join us for Food, Fun, and Faith!



*We had so much fun at our Great Church Camp Out that we are planning another one for next year!*

## **We are St. John's!**

*Our parish community remains strong because of you and your support*

What exactly is stewardship? The Episcopal Church sees stewardship as more than simply contributing money to the church. Stewardship also means contributing time, talents and volunteering for our ministries and mission.

How has St. John's done over the past 18 months? Well, we are entering the Fall of 2021 in a sound financial position. Reverend Jill is here full time, our offices are open and staffed, in-person services and meetings are resuming, and our Outreach efforts to Guatemala and Chester Eastside Inc. are ongoing.

*A Jeep full of supplies for Chester Eastside*



How did we achieve this? It was you, our parishioners, individually and as a group who made all this possible. You are good stewards, and despite the hardships many of us faced, you continued to support St. John's, its mission and its people. You made it happen. Optimism, faith, hard work – you offered it all.

It takes a bit over \$300,000 annually to operate our parish at its current level. Your pledges fund most of that income and are used to support church activities such as education, Sunday School, pastoral care and other programs. Your contributions provide salaries for

our staff, pay for insurance, taxes (yes, we do pay property taxes), utilities, office expenses, property and equipment etc. Running St. John's is much like running a home or a business. All of these expenses are detailed in the annual report so you can see how your financial contributions are used.

Additionally we are blessed with significant time and talent contributions. As an example, the rectory renovation cost was reduced by approximately \$30,000 due to volunteers who handled detailed contract negotiations, project management and skilled labor. Our wonderful, new A/V system for Facebook and YouTube broadcasts was researched, ordered, set up and is run by volunteers including youth members. A volunteer replaced the soffits on our church, others maintain our flower beds. And on it goes – altar guild, fellowship, event planning, coffee hour, and book clubs are enjoyed by many due to the efforts of our dedicated volunteers. If we may borrow a phrase from a famous Pennsylvania university: "WE ARE ST. JOHN'S!" Our stewardship is strong...But your continued support is needed.

The 2022 Stewardship Campaign will begin this Fall. Until then, think about what St. John's means to you and your family and pledge according to that and your means. Please also consider what time and talent you can provide. And, as always, please share your ideas and concerns. After all – "We are St. John's!"



*We had a magical VBS for our children in August*

## **Parish Hall Renovations: *Finishing What We Started***

In the summer of 2019, most of the work for Phase 2 of our Capital Improvements to the Parish Hall was complete. Missing from this was the Dish Storage room across from the kitchen and getting the second floor Attic useable. We are excited to announce that our contractor, Chris Ryan (Glenveagh Construction), has started work this week to complete both the Dish Room and Attic for Phase 2.

Even more exciting is that Glenveagh Construction will begin on Phase 3 of our Parish Hall renovations as soon as Chris gets the work permits from Concord Township (which hopefully will be next week). To recap, Phase 3 is the renovation of the administrative offices. This includes construction of a handicap accessible walkway in the front of the building, replacement of the existing windows with energy efficient windows, renovation of the office to provide a reception area that is visible to the parish administrator, and enlargement of the rector's office to provide more privacy for Rev. Jill. A plan diagram is shown below.

During the construction, April McKenzie's office will be moved temporarily to the Meditation Room. Reverend Jill's office will be moved the Choir Room. Equipment and supplies will be stored around the building. It is expected that there will be only temporary disruptions when these moves are made. Chris estimates that total construction will take about 3 months.

Recognizing that many didn't want another "big ask" after so much fund raising that has been done recently, the Vestry approved a "silent ask" campaign. Phase 3 is made possible through the generous donations of several of our parishioners who have previously supported our Capital Campaign. The Vestry is making up the shortfall. For all of you who have made this work possible through your generous donations, thank you! And for those who would like to support this final phase to our Capital Campaign, please contact Paul Costello to donate.

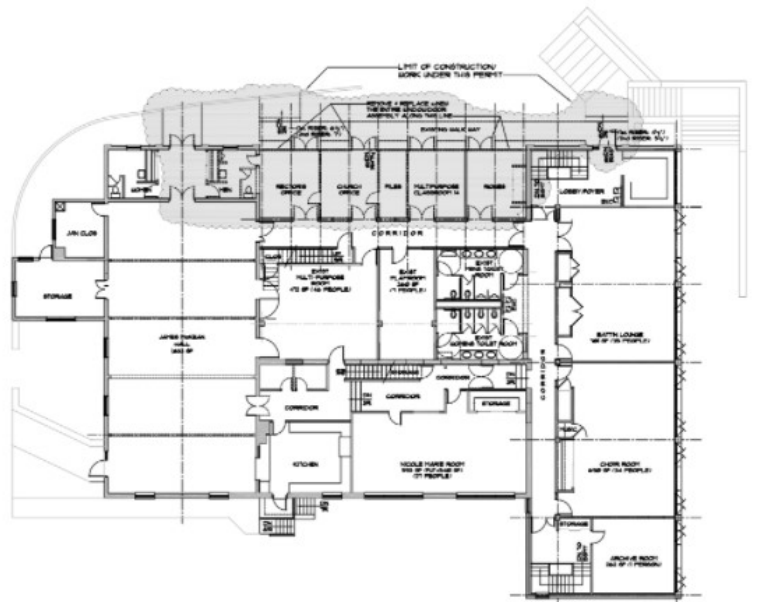

### **You Gotta Sing When the Spirit Says Sing!**

This Fall we will incorporate more SINGING into our joyful worship. Music Director Jess Villante has been closely following all the best practices for music during this time of pandemic. New research (via the Colorado Study) allows for masked singing for 50 minutes (that's continuous singing) and decreases the space between singers. All of this means that we can sing more hymns and invite those who wish to be in the Choir to return to the choir stall!

Our Choir will return in October. If you would like to join our Choir, reach out to Jess.

# September 2021

August '21							October '21						
S	M	T	W	T	F	S	S	M	T	W	T	F	S
1	2	3	4	5	6	7	3	4	5	6	7	8	9
8	9	10	11	12	13	14	10	11	12	13	14	15	16
15	16	17	18	19	20	21	17	18	19	20	21	22	23
22	23	24	25	26	27	28	24	25	26	27	28	29	30
29	30	31					31						

Sunday	Monday	Tuesday	Wednesday	Thursday	Friday	Saturday
29	30	31	1	2	3	4
5 8:00 Worship 10:00 Worship	6	7	8 10-11:30 Thu Café 11:30 Eucharist	9 10-11:30 Thu Café 11:30 Eucharist 7:00 Vestry	10	11 10:00 Holy Hiking at Valley Forge Nat'l Park
12 8:30 Worship 9:30 S Sch & Coffee Hr 10:30 Outdoor Worship with Ice Cream Celebration	13	14	15 6:30-8pm Welcome Class: Baptism	16 10:30 Maris Grove Service	17	18
19 8:30 Worship 9:30 S Sch & Coffee Hr 10:30 Worship	20	21 7-8:30 WSFG	22 6:30-8pm Welcome Class: History of the Church 6-7:30pm Women's Dinner	23 10-11:30 Thu Café 11:30 Eucharist	24	25
26 8:30 Worship 9:30 S Sch & Coffee Hr 10:30 Worship 4-5:45 Youth Group	27	28	29 6:30-8pm Welcome Class: Instructed Eucharist	30	1	2

# October 2021

September '21

S M T W T F S  
 5 6 7 8 9 10 11  
 12 13 14 15 16 17 18  
 19 20 21 22 23 24 25  
 26 27 28 29 30

November '21

S M T W T F S  
 1 2 3 4 5 6  
 7 8 9 10 11 12 13  
 14 15 16 17 18 19 20  
 21 22 23 24 25 26 27  
 28 29 30

Sunday	Monday	Tuesday	Wednesday	Thursday	Friday	Saturday
26	27	28	29	30	1	2
3	4	5	6	7	8	9
8:30 Worship 9:30 S Sch & Coffee Hr 10:30 Worship - Outdoors			6:30-8pm W/WJB?			10:00 Holy Hiking
10	11	12	13	14	15	16
8:30 Worship 9:30 S Sch & Coffee Hr 10:30 Worship 4-5:45 Youth Group				10-11:30 Thu Café 11:30 Healing Prayers 7:00 Vestry		
17	18	19	20	21	22	23
8:30 Worship 9:30 S Sch & Coffee Hr 10:30 Worship		7-8:30 W/SFG		10:30 Manis Grove Service		
24	25	26	27	28	29	30
8:30 Worship 9:30 S Sch & Coffee Hr 10:30 Worship 4-5:45 Youth Group			6-7:30p Women's Dinner	10-11:30 Thu Café 11:30 Eucharist	5:30 Halloween Fun: Outdoor games & movie	
31	1	Notes				
8:30 Worship 9:30 S Sch & Coffee Hr 10:30 Worship	<b>St. John's Episcopal Church</b> 576 Concord Rd Glen Mills, PA 19342 610-459-2994					